

Einführung der Serien PM-25, PM-45 und PM-65

-

Vergleich zu den bisherigen Serien PM-24, PM-44, PM-54 und PM-64



Inhaltsübersicht

Informationen zu den Umschlüsselungen von

- **der Serie PM-24 zur Serie PM-25** **Seite 3**
- **der Serie PM-44 zur Serie PM-45** **Seite 8**
- **der Serie PM-54 zur Serie PM-65** **Seite 13**
- **der Serie PM-64 zur Serie PM-65** **Seite 18**
- **Zubehör zu der Serie PM-65** **Seite 24**

Die Serie PM-25 im Vergleich zur Serie PM-24

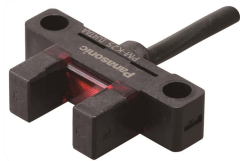

PM-K25



PM-L25



PM-U25



PM-F25



PM-R25

Technische Eckdaten im Vergleich

Serie	NPN	PM-*25	PM-*24
	PNP	PM-*25-P	PM-*24P
Gabelweite		6mm	5mm
Kleinstes detektierbares Objekt		0,8mm x 1,2mm (undurchsichtig)	0,8mm x 1,8mm (undurchsichtig)
Hysterese		max. 0,05mm	max. 0,05mm
Wiederholgenauigkeit		max. 0,01mm	max. 0,03mm
Betriebsspannung		5 bis 24 V DC	5 bis 24 V DC
Stromaufnahme		max. 15mA	max. 15mA
Ausgang Transistor		max. 50mA	max. 50mA
Schaltlogik		Hell-EIN / Dunkel-EIN	Hell-EIN / Dunkel-EIN
Verpolungsschutz		eingebaut	-
Funktionsanzeige		orange LED	orange LED
Ansprechzeit		Hell-EIN: max. 20µs / Dunkel-EIN: max. 80µs	Hell-EIN: max. 20µs / Dunkel-EIN: max. 100µs
IP-Schutzklasse		IP64	-
Umgebungstemperatur		-25°C bis +55°C (ohne Kondensation)	-25°C bis +55°C (ohne Kondensation)
Montageschrauben		M2 und M3	M2

Serie PM-25

Montage mit M2- oder M3-Schrauben möglich

PM-K25

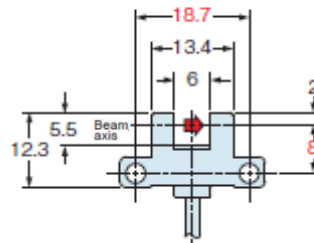
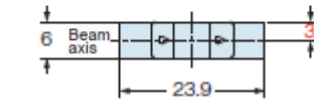

*Montage mit 18mm Abstand möglich

PM-L25

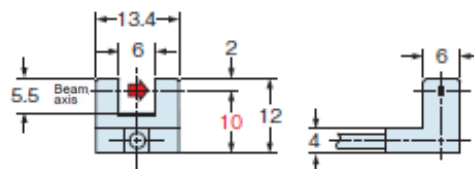
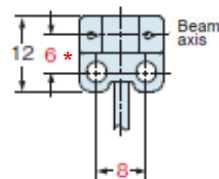

*Montage mit 5,5mm Abstand möglich

PM-K24

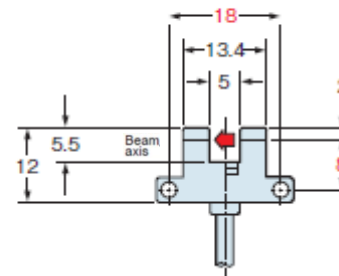
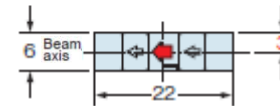

PM-L24

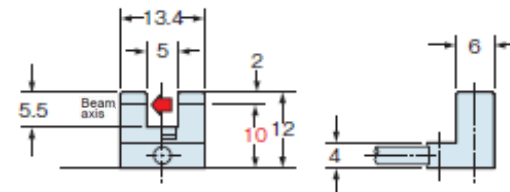
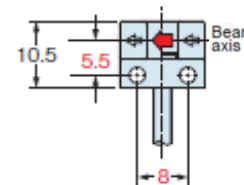

PM-F25

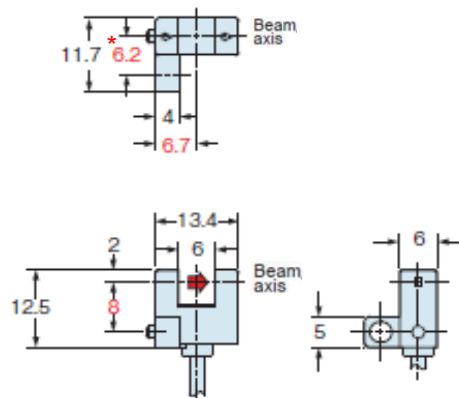

*Montage mit 5,5mm Abstand möglich

PM-R25

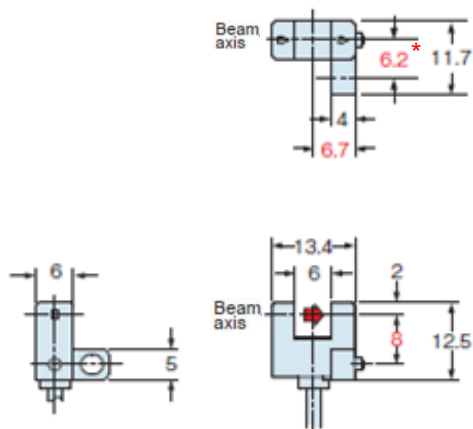

*Montage mit 5,5mm Abstand möglich

PM-F24

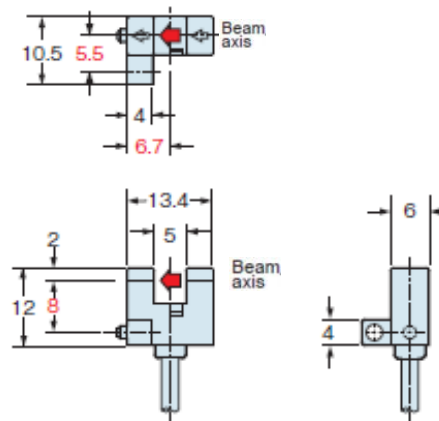

PM-R24

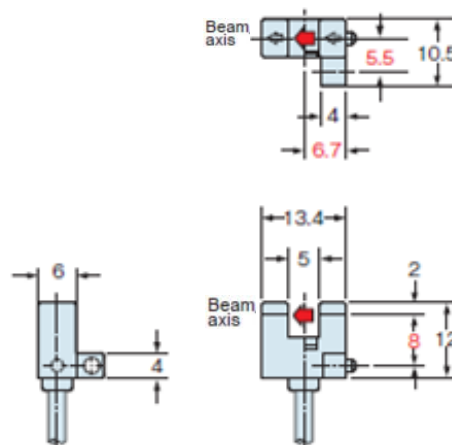

PM-U25

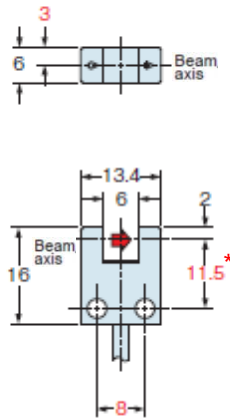

*Montage mit 12mm Abstand möglich

PM-U24

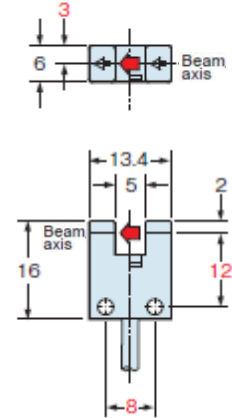

Die Serie PM-45 im Vergleich zur Serie PM-44



PM-K45



PM-T45



PM-L45



PM-Y45



PM-F45



PM-R45

Technische Eckdaten im Vergleich

Serie	NPN	PM-*45	PM-*44
	PNP	PM-*45-P	PM-*44P
Gabelweite		6mm	5mm
Kleinstes detektierbares Objekt		0,8mm x 1,2mm (undurchsichtig)	0,8mm x 1,8mm (undurchsichtig)
Hysterese		max. 0,05mm	max. 0,05mm
Wiederholgenauigkeit		max. 0,01mm	max. 0,03mm
Betriebsspannung		5 bis 24 V DC	5 bis 24 V DC
Stromaufnahme		max. 15mA	max. 15mA
Ausgang Transistor		max. 50mA	max. 50mA
Schaltlogik		Hell-EIN / Dunkel-EIN	Hell-EIN / Dunkel-EIN
Verpolungsschutz		eingebaut	-
Funktionsanzeige		orange LED	orange LED
Ansprechzeit		Hell-EIN: max. 20µs / Dunkel-EIN: max. 80µs	Hell-EIN: max. 20µs / Dunkel-EIN: max. 100µs
IP-Schutzklasse		IP64	-
Umgebungstemperatur		-25°C bis +55°C (ohne Kondensation)	-25°C bis +55°C (ohne Kondensation)

PM-K45

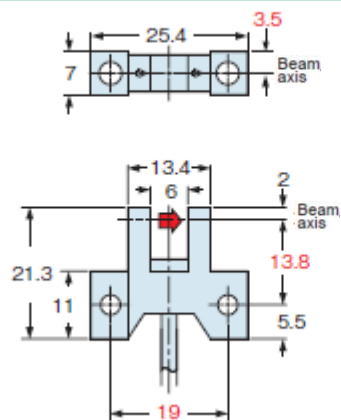

PM-K44

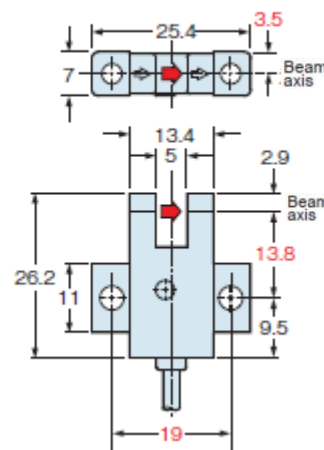

PM-L45

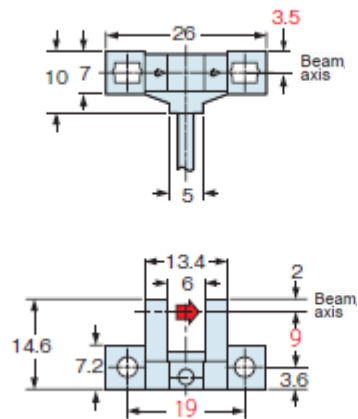

PM-L44

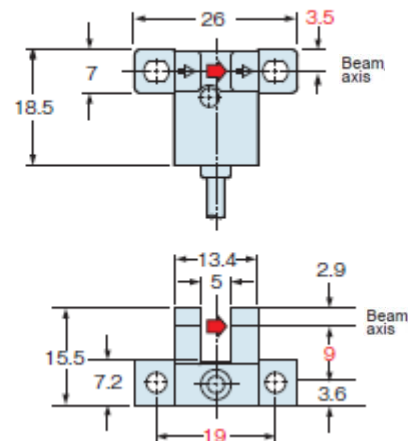

PM-T45

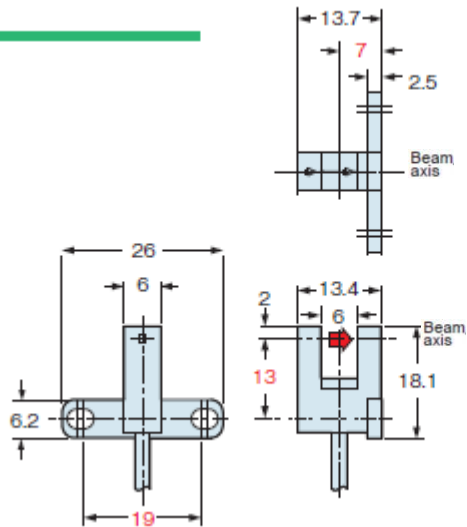

PM-T44

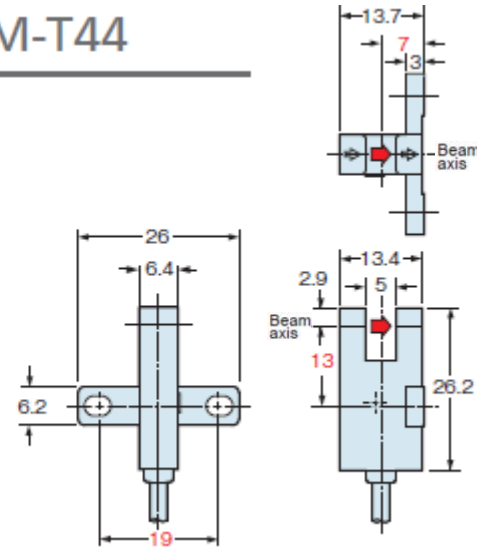

PM-Y45

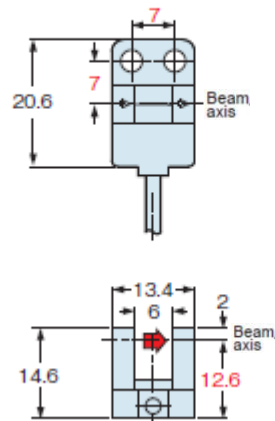

PM-Y44

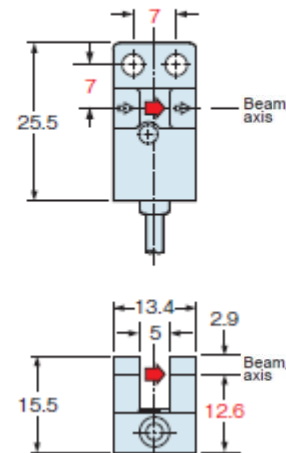

PM-F45

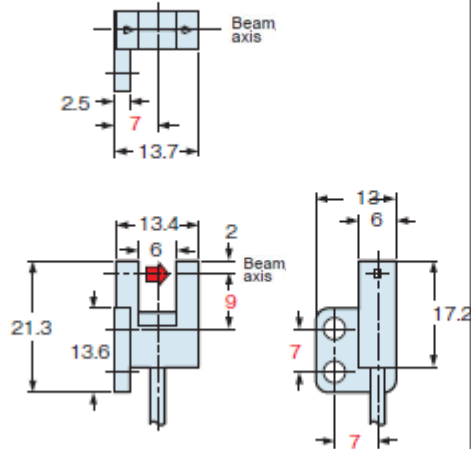

PM-F44

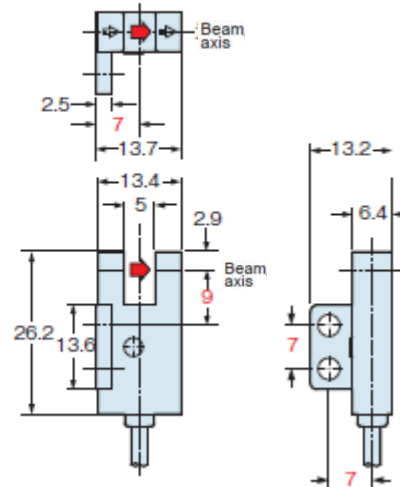

PM-R45

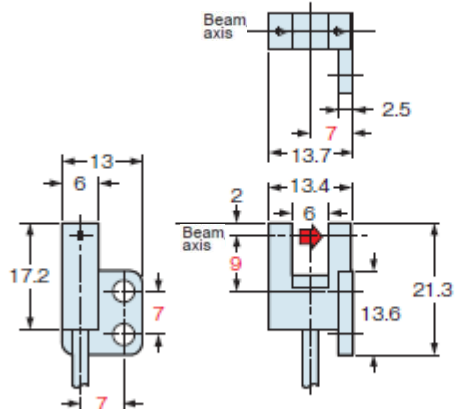

PM-R44

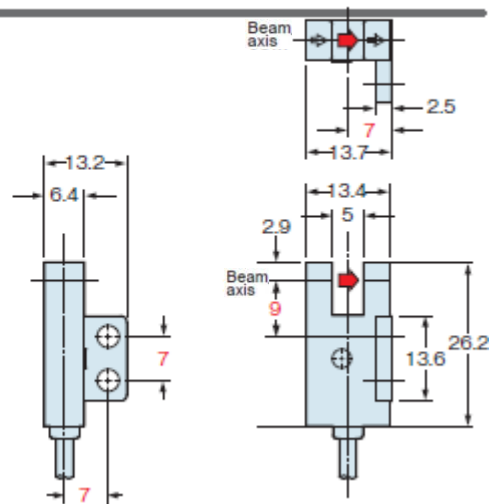

Die Serie PM-65 im Vergleich zur Serie PM-54



PM-K65



PM-T65



PM-T65W



PM-Y45



PM-F65

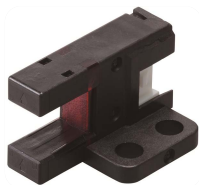

PM-F65W



PM-R65



PM-R65W

Technische Eckdaten im Vergleich

Serie	NPN	PM-*65	PM-*54
	PNP	PM-*65-P	PM-*54P
Gabelweite		6mm	5mm
Kleinstes detektierbares Objekt		0,8mm x 1,2mm (undurchsichtig)	0,8mm x 1,8mm (undurchsichtig)
Hysterese		max. 0,05mm	max. 0,05mm
Wiederholgenauigkeit		max. 0,01mm	max. 0,03mm
Betriebsspannung		5 bis 24 V DC	5 bis 24 V DC
Stromaufnahme		max. 15mA	max. 15mA
Ausgang Transistor		max. 50mA	max. 50mA
Schaltlogik		Hell-EIN / Dunkel-EIN	Hell-EIN / Dunkel-EIN
Verpolungsschutz		eingebaut	-
Funktionsanzeige		orange LED	orange LED
Ansprechzeit		Hell-EIN: max. 20µs / Dunkel-EIN: max. 80µs	Hell-EIN: max. 20µs / Dunkel-EIN: max. 100µs
IP-Schutzklasse		IP64	-
Umgebungstemperatur		-25°C bis +55°C (ohne Kondensation)	-25°C bis +55°C (ohne Kondensation)

PM-K65

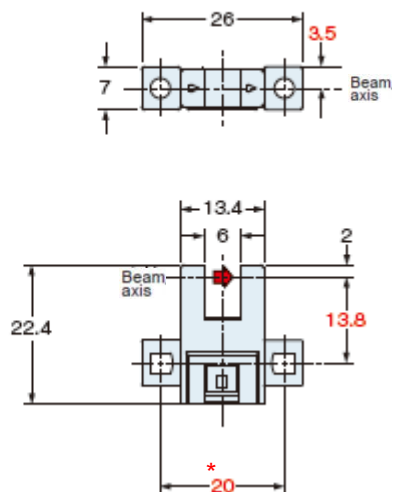

*19mm pitch also attachable

PM-L65

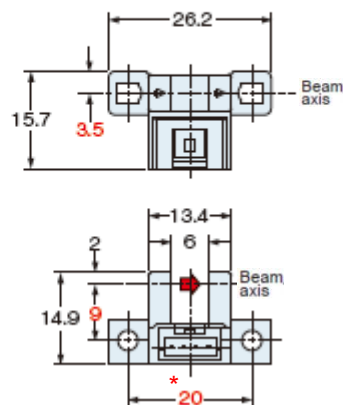

*19mm pitch also attachable

PM-K54

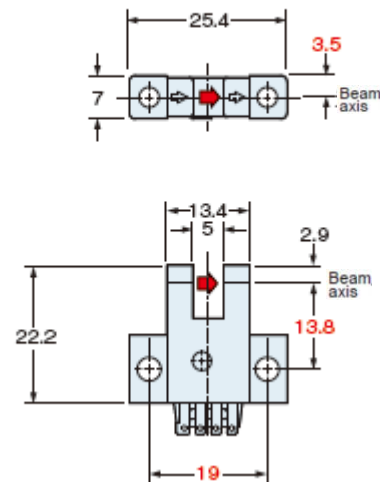

PM-L54

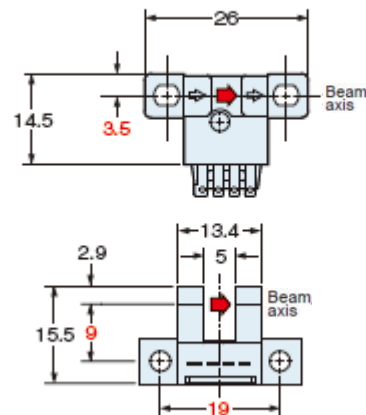

PM-T65

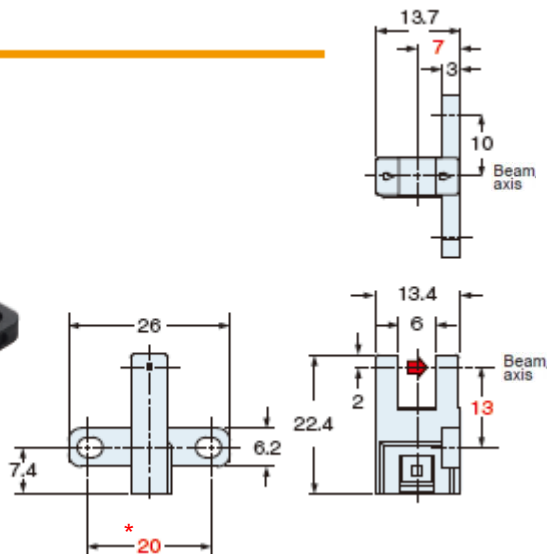

*19mm pitch also attachable

PM-Y65

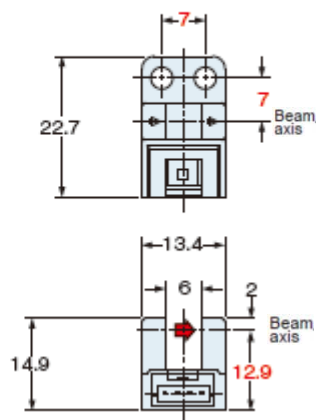

PM-T54

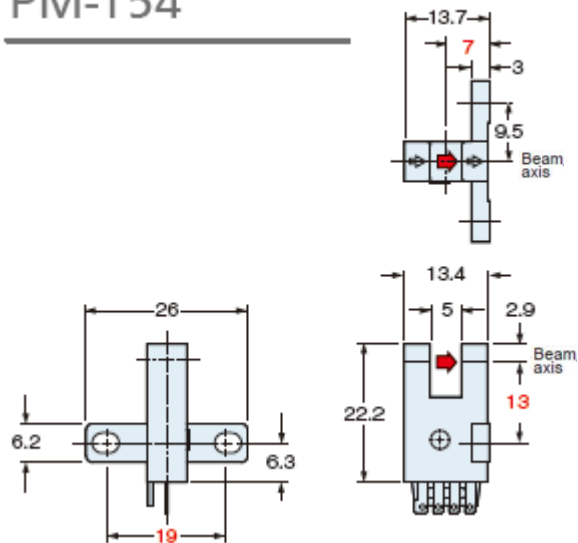

PM-Y54

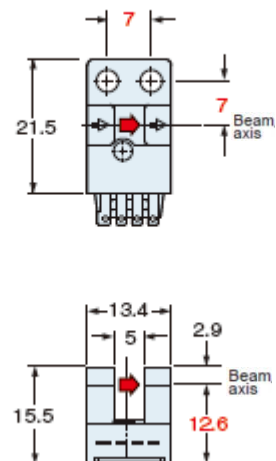

PM-F65W

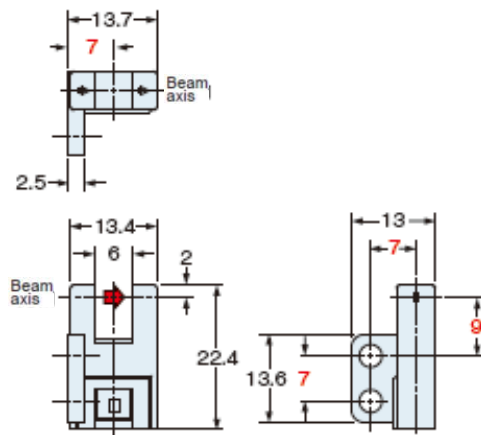

PM-F54

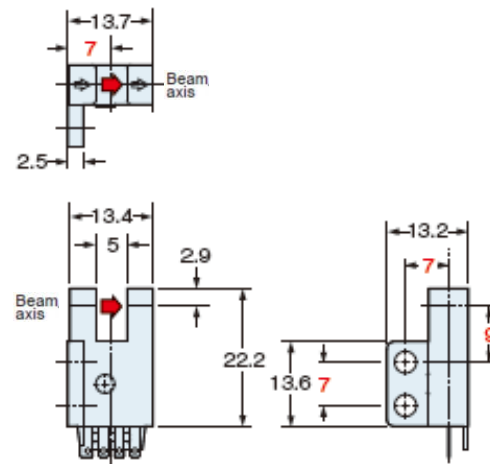

PM-R65W

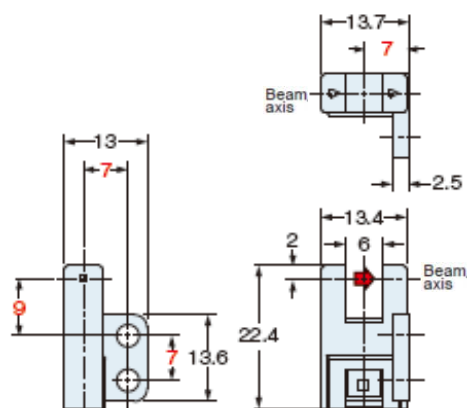

PM-R54

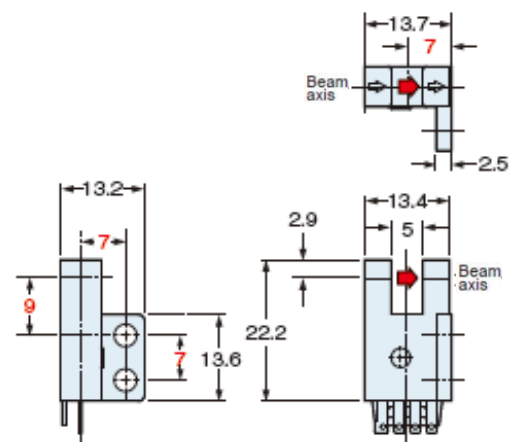

Die Serie PM-65 im Vergleich zur Serie PM-64



PM-K65



PM-T65



PM-T65W



PM-Y45



PM-F65

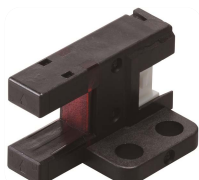

PM-F65W



PM-R65



PM-R65W

Technische Eckdaten im Vergleich

Serie	NPN	PM-*65	PM-*64
	PNP	PM-*65-P	PM-*64P
Gabelweite		6mm	5mm
Kleinstes detektierbares Objekt		0,8mm x 1,2mm (undurchsichtig)	0,8mm x 1,8mm (undurchsichtig)
Hysterese		max. 0,05mm	max. 0,05mm
Wiederholgenauigkeit		max. 0,01mm	max. 0,03mm
Betriebsspannung		5 bis 24 V DC	5 bis 24 V DC
Stromaufnahme		max. 15mA	max. 15mA
Ausgang Transistor		max. 50mA	max. 50mA
Schaltlogik		Hell-EIN / Dunkel-EIN	Hell-EIN / Dunkel-EIN
Verpolungsschutz		eingebaut	-
Funktionsanzeige		orange LED	orange LED
Ansprechzeit		Hell-EIN: max. 20µs / Dunkel-EIN: max. 80µs	Hell-EIN: max. 20µs / Dunkel-EIN: max. 100µs
IP-Schutzklasse		IP64	-
Umgebungstemperatur		-25°C bis +55°C (ohne Kondensation)	-25°C bis +55°C (ohne Kondensation)

PM-K65

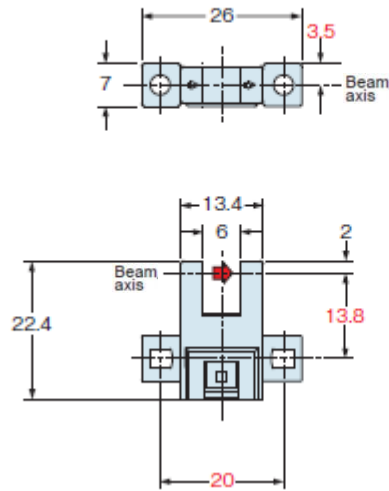

PM-K64

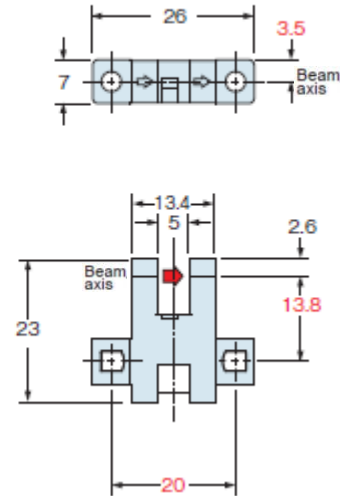

PM-L65

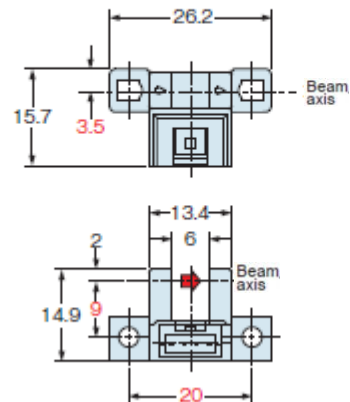

PM-L64

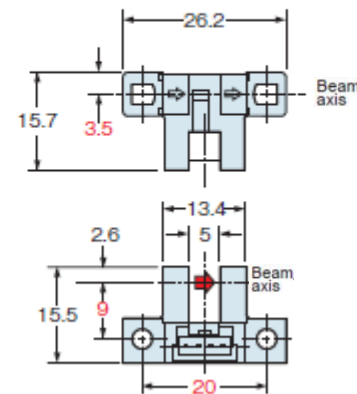

PM-T65

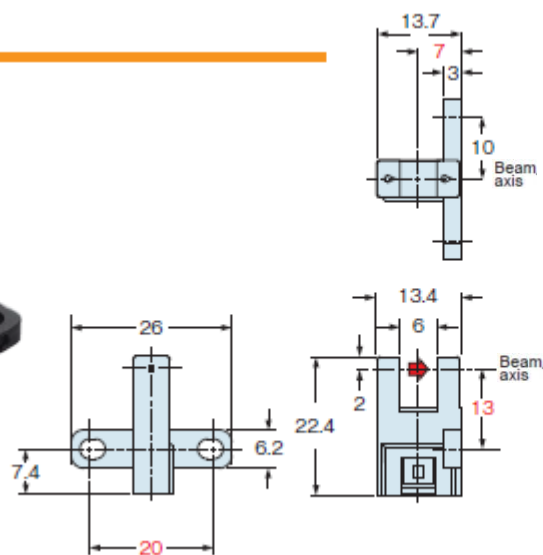

PM-T64

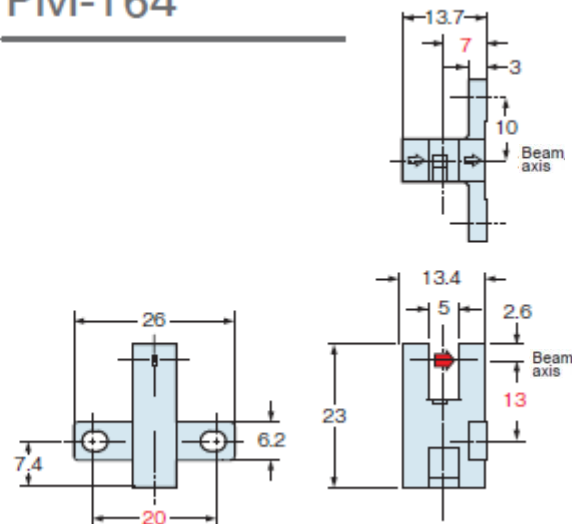

PM-T65W

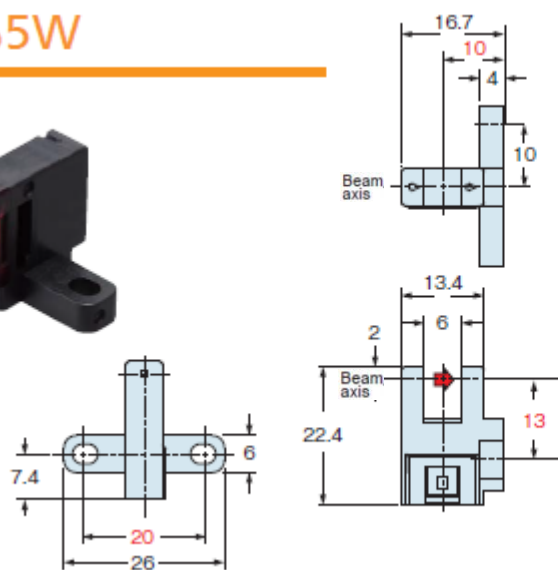

PM-T64W

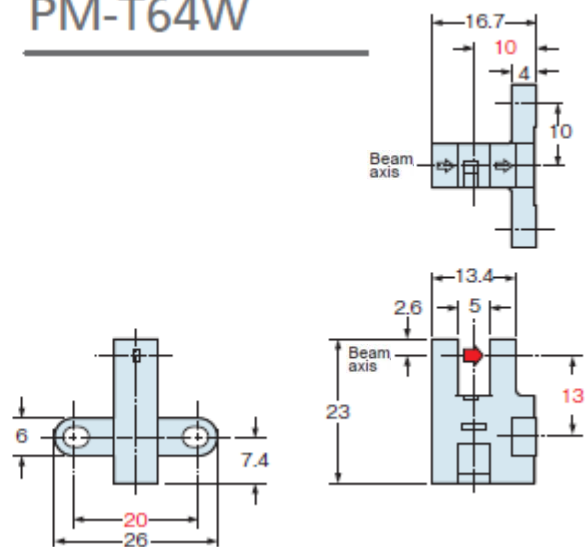

PM-Y65

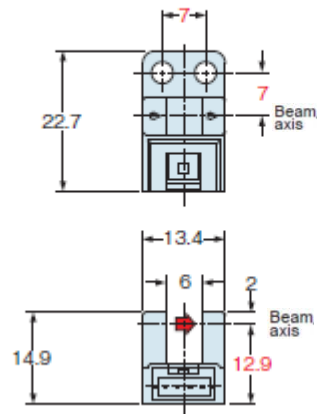

PM-Y64

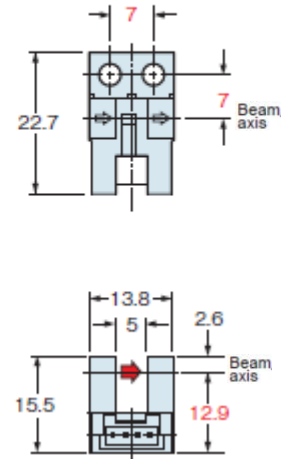

PM-F65

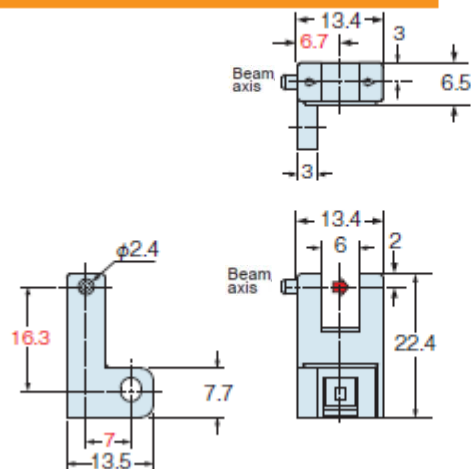

PM-F64

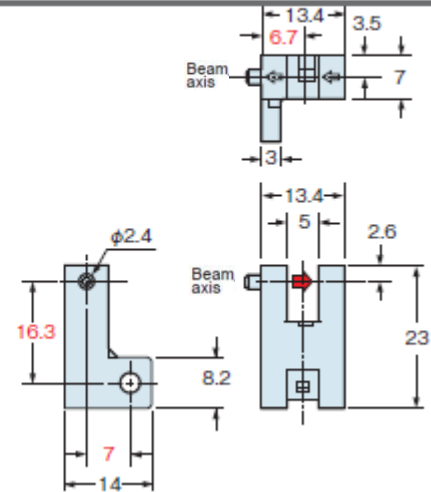

PM-R65

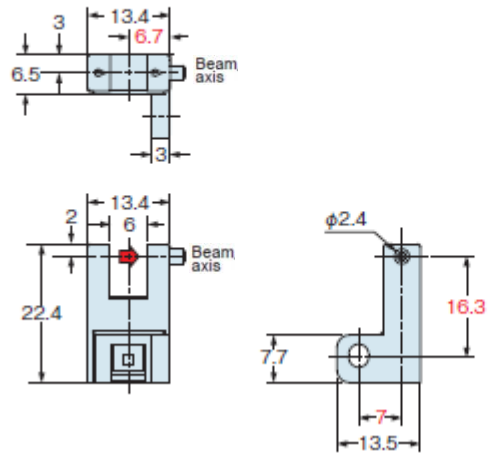

PM-R64

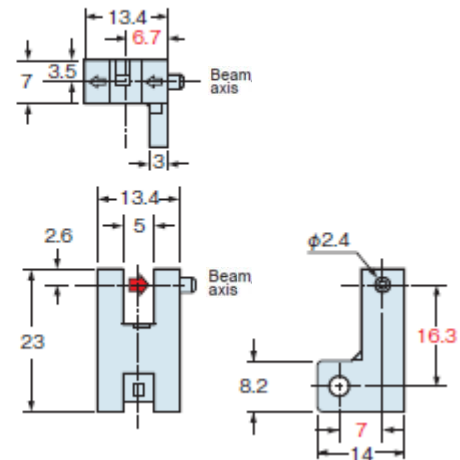

Zubehör zu der Serie PM65

Zubehör zu den Serien PM-64 und PM-65

Die Serie PM-54 hat einen Lötflächenanschluss, die Serien PM-65 / PM-64 verfügen über einen JST-Steckanschluss

Steckanschluss Serie PM-54

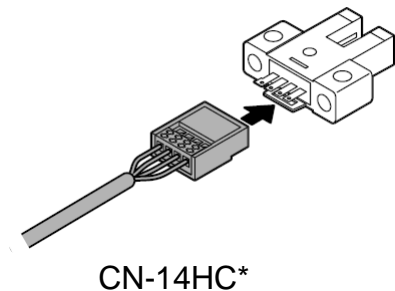

Steckanschluss (JST) Serie PM-64 und PM-65

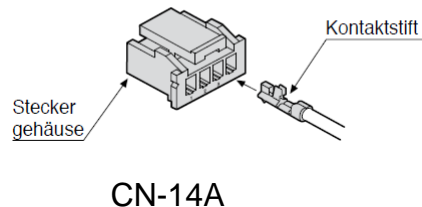
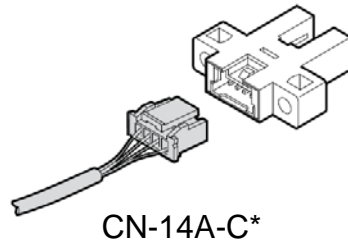

Art. Nr.	Beschreibung
CN-14A-C1	Steckerkabel, 1m
CN-14A-C2	Steckerkabel, 2m
CN-14A-C3	Steckerkabel, 3m
CN-14A-C5	Steckerkabel, 5m
CN-14A	Set mit 10x Steckergehäuse und 40 Stiften